



25 Mulberry Mead, Whitchurch, RG28 7BE
Guide Price £140,000



25 Mulberry Mead, Whitchurch, Guide Price £140,000

PROPERTY DESCRIPTION BY Mr Dion McArthur

Nestled in the heart of Whitchurch, this charming two-bedroom top floor apartment is situated within the esteemed Mulberry Mead retirement complex, designed specifically for those aged 55 and over. Offering delightful views over the picturesque town, this residence combines comfort with convenience, making it an ideal choice for those seeking a peaceful yet vibrant community.

The apartment boasts a spacious layout, allowing for a comfortable living experience. With no onward chain and vacant possession, you can move in without delay, making it a hassle-free option for prospective buyers. The top floor location not only provides a sense of privacy but also enhances the lovely views that can be enjoyed from the living spaces.

Living in the centre of Whitchurch means you are just a stone's throw away from local amenities, including shops, cafes, and parks, ensuring that everything you need is within easy reach. This property is perfect for those looking to embrace a relaxed lifestyle while remaining connected to the community.

In summary, this two-bedroom apartment at Mulberry Mead offers a unique opportunity to enjoy a serene living environment in a prime location. With its appealing features and the added benefit of no onward chain, this property is not to be missed.





Whitchurch is situated on the River Test in North Hampshire with a population of approximately 4,500. The town is conveniently situated 13 miles south of Newbury, 12 miles north of Winchester, 8 miles east of Andover and 12 miles west of Basingstoke. Much of the town is in a conservation area, with an abundance of wildlife and local history. Whitchurch has a wide range of amenities, including; convenience stores, Post Office, bakery, coffee shop, many pubs and places to eat. The doctor's surgery, dental practice and veterinary clinic are all centrally located. Whitchurch boasts Good and Outstanding OFSTED-rated schools and nursery. There is a direct train line from Whitchurch station to London Waterloo, and also easy road links to the A34 and A303.





APPROXIMATE GROSS INTERNAL AREA = 537 SQ FT / 49.9 SQ M

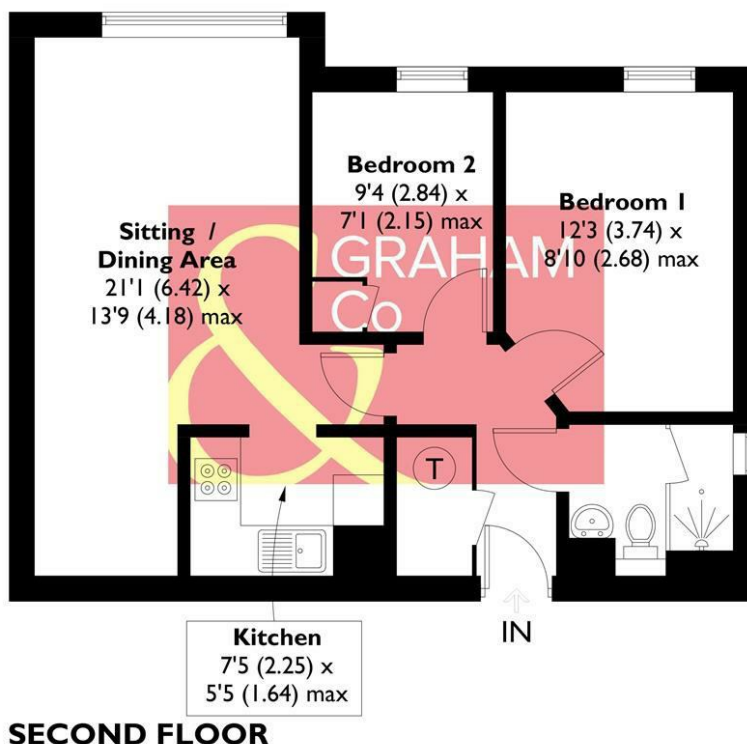

This plan is for layout guidance only. Not drawn to scale unless stated. Windows and door openings are approximate. Whilst every care is taken in the preparation of this plan, please check all dimensions, shapes and compass bearings before making any decisions reliant upon them. Created by Emzo Marketing (ID1262971)

Produced for Graham & Co

MORTGAGE ADVICE

Across The Market Mortgages

An independent Mortgage brokerage offering expert advice from across the whole market. Whether you are a first-time buyer, home mover, remortgaging or buying a Buy-To-Let investment. Tristan can provide expert & reliable advice, in a clear jargon free language. Book a free consultation today.

E - tristan@atmmortgages.com M - 07545320380

www.atmmortgages.com

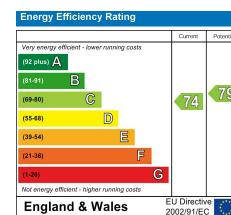

Tax Band: A



OPEN 7 DAYS

If you are considering selling your home please contact us today for your free no obligation valuation

IMPORTANT: We would like to inform prospective purchasers that these sales particulars have been prepared as a general guide only. A detailed survey has not been carried out, nor the services, appliances and fittings tested. Room sizes should not be relied upon for furnishing purposes and are approximate. If floor plans are included, they are for guidance only and illustration purposes only and may not be to scale. If there are any important matters likely to affect your decision to buy, please contact us before viewing the property.

